

Starting capacitors

Description

The electrolytic capacitor has high capacitance (μF value) able to provide a high starting torque to the motor.



Technical data

Rated Voltage	EL 250V - 320VAC
Rated Frequency	50 / 60 Hz
Working Temperature	-25°C / +75°C
Operating class	1,67%
Loss Factor	≤0.10 Typical Value
Test Voltage between terminals	1.4Vn x 1 sec
Test Voltage between terminals and case	1.5kV x 5 sec
Endurance Test	500 h
Reference Standard	EN60252-2

Typical applications

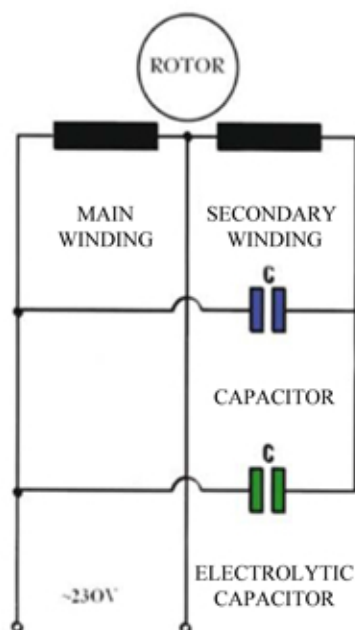

Executions

Case	PIa-PB
Terminals	FD
No-C: Capacitors can be provided without protective cap	
No-FB: Capacitors can be provided without fixing bracket	

Starting capacitors



Applications typiques

Type 250V	Case : Pla-PB Ø × H (mm)	
C40 / 50	46	98
C50 / 63	46	98
C63 / 80	46	98
C80 / 100	46	98
C100 / 125	46	98
C125 / 160	46	98
C160 / 200	46	98
C200 / 250	46	98
C250 / 315	46	98
C315 / 400	46	98

Approvals

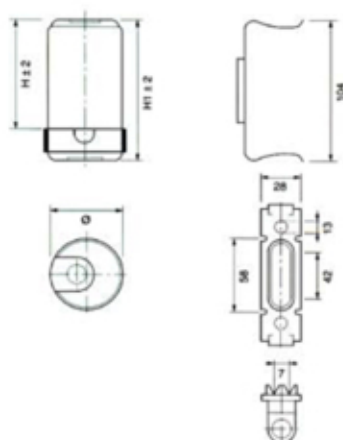
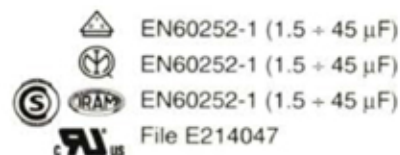

Pla-PB

Plane base self extinguishing (V2) plastic case

FD

Double tag 6.3mm x 0.8mm.

Motor power 250 V		200 % - 50Hz 200 µF	
HP	KW	220 V	280 V
1/10	0,074	20	10
1 / 4	0,183	50	25
1/2	0,368	100	50
3/4	0,552	150	80
1	0,736	200	100
1,5	1,104	300	150
2	1,472	--	200